

What's New in Part Modeler 2014 R1

Enhancements to the Loft Procedure

Enhancements have been made to the Loft procedure in Part Modeler 2014 R1. It is now possible to loft dissimilar shapes and add guide curves to the lofted profile allowing advanced lofting operations to be completed.

Limitations:

- Guide curves can only be constructed with the 3D Wireframe tools (3D lines, 3D Cubic Splines and 3D Nurbs).

See [Creating a Lofted Component](#) and [New Component Dialog Box \(Loft\)](#) for more information.

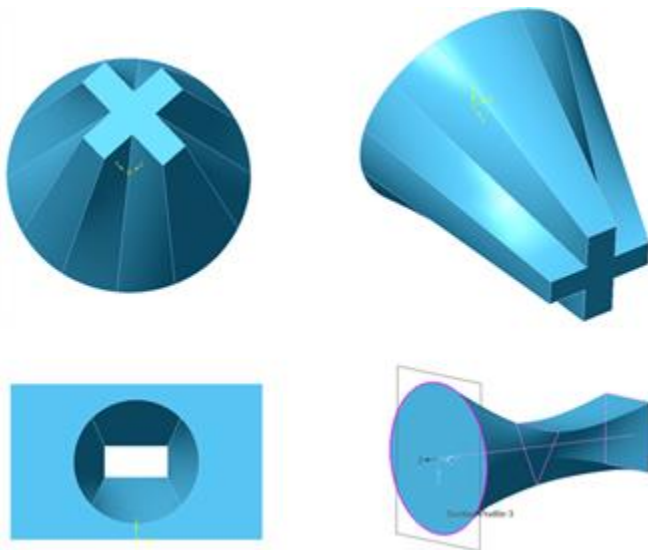

Enhancement to the Sweep Procedure

Enhancements have been made to the Sweep procedure in Part Modeler 2014 R1. It is now possible to add guide curves to the swept profile allowing more advanced sweep operations to be completed.

Limitations:

- Guide curves can only be constructed with the 3D Wireframe tools (3D lines, 3D Cubic Splines and 3D Nurbs).
- Limited to using 3 Guide Curves.
- The profile will be swept to the length of the Drive Plane or the shortest Guide Curve.

See [Creating a Swept Component](#) for more information.

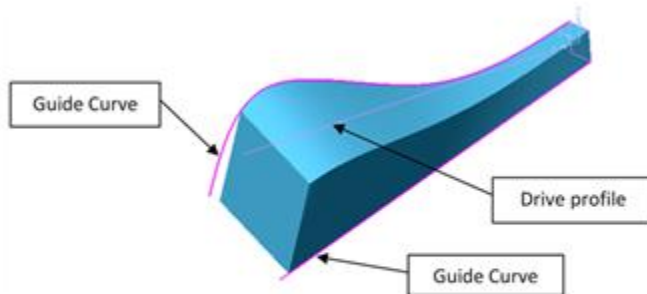

Finding and Editing Fillets on a Third Party Model

Feature Finder has been enhanced to Find and Edit Fillets on Third Party imported solid models.

Limitations:

- Variable radii will not be found.
- Freeform curved faces will not be found.

See [Feature Finding Fillets](#) for more information.

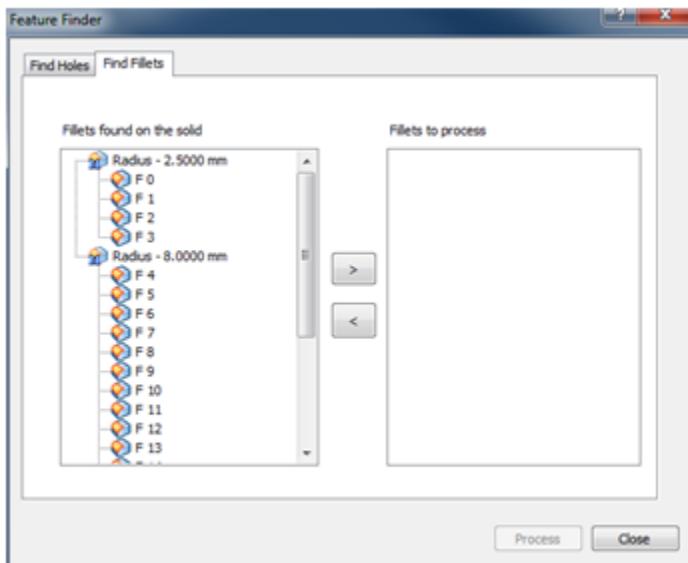
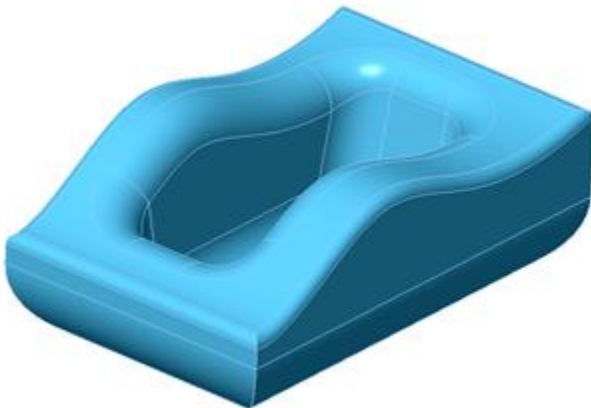

Fly Through View Mode

We have introduced a simple 'Fly Through' the model viewing mode to Part Modeler. This new functionality will allow users to fly through the model and examine internal surfaces that previously would not have been seen.

Fly Through can also be controlled using a 3D SpaceMouse.

Benefits include:

- Examination of internal solid features; features that are difficult to see.
- Help the user to gain a better understanding of their model.
- Help the user to communicate their designs to others.

Limitations:

- Currently only a viewing mode within Part Modeler.

See [Using Fly Through](#) for more information.

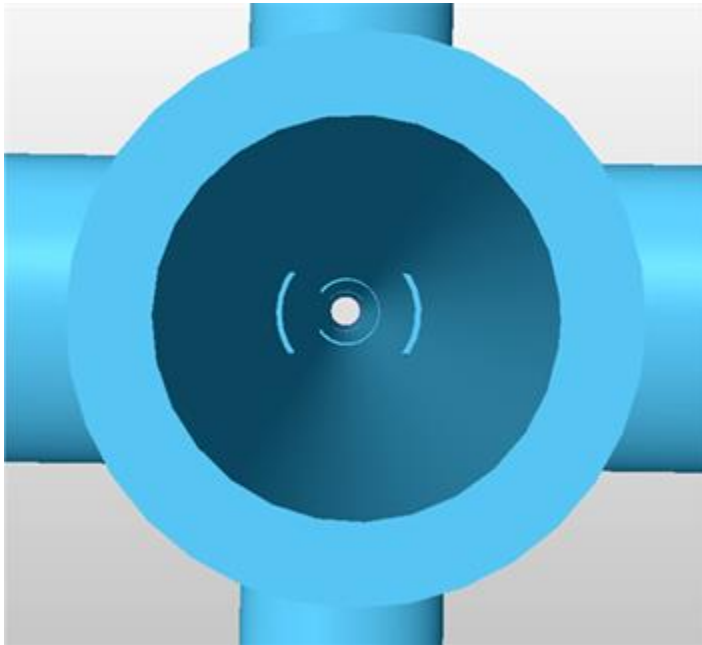

Translate Sheet Bodies

We have introduced a new **Translate sheet bodies** option on the Translation tab of the System options which will translate sheet bodies into solid models.

See [System Options Dialog Box](#) for more information.

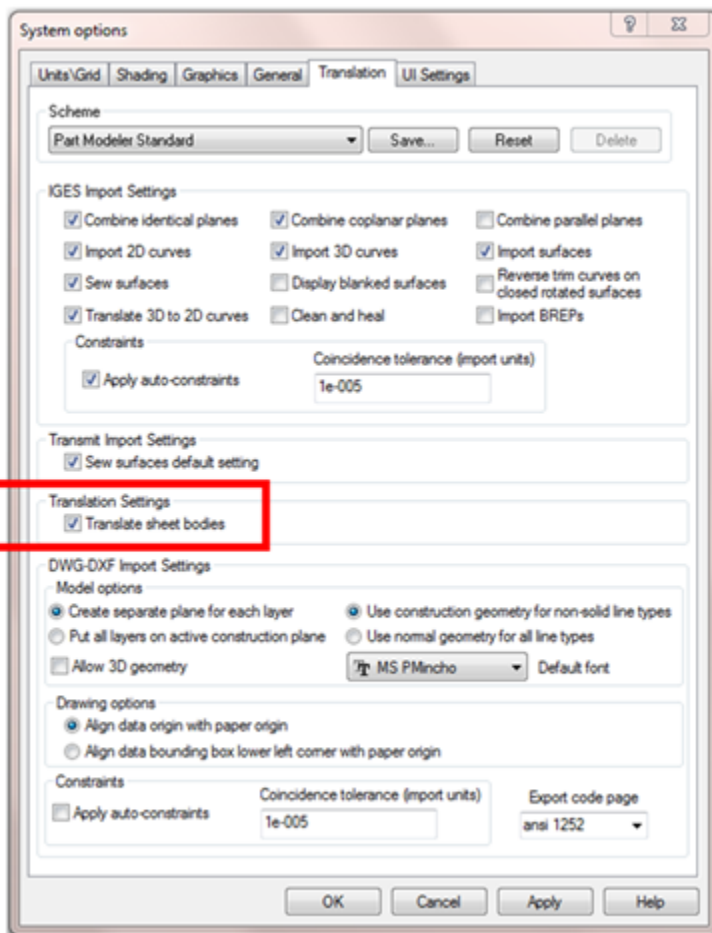

What's New in Part Modeler 2014 R2

2D to 3D Modelling Procedure

The 2D to 3D Modelling Procedure has been re-introduced into Part Modeler. It is now possible to create 3D solid models from 2D geometry (DXF, DWG, etc) within Part Modeler.

This will:

- Allow a solid model to be developed much quicker than modelling.
- Reduce translation errors when converting from 2D to 3D.
- Improve visualisation of a part when it is in a 3D (solid model) format.
- Produce a solid model that can be manipulated by intelligent solids based manufacturing within Edgcam.

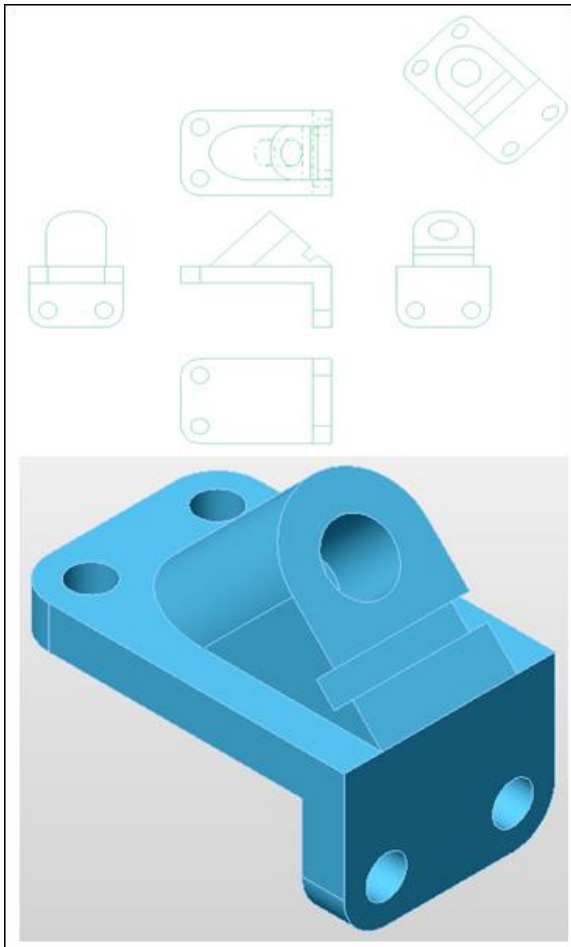

New Healing Options

We have introduced a new **Healing Options** preference on the Translation tab of the System options which enables STEP and IGES files to be Healed or Simplified and Healed (default).

See [System Options Dialog Box](#) for more information.

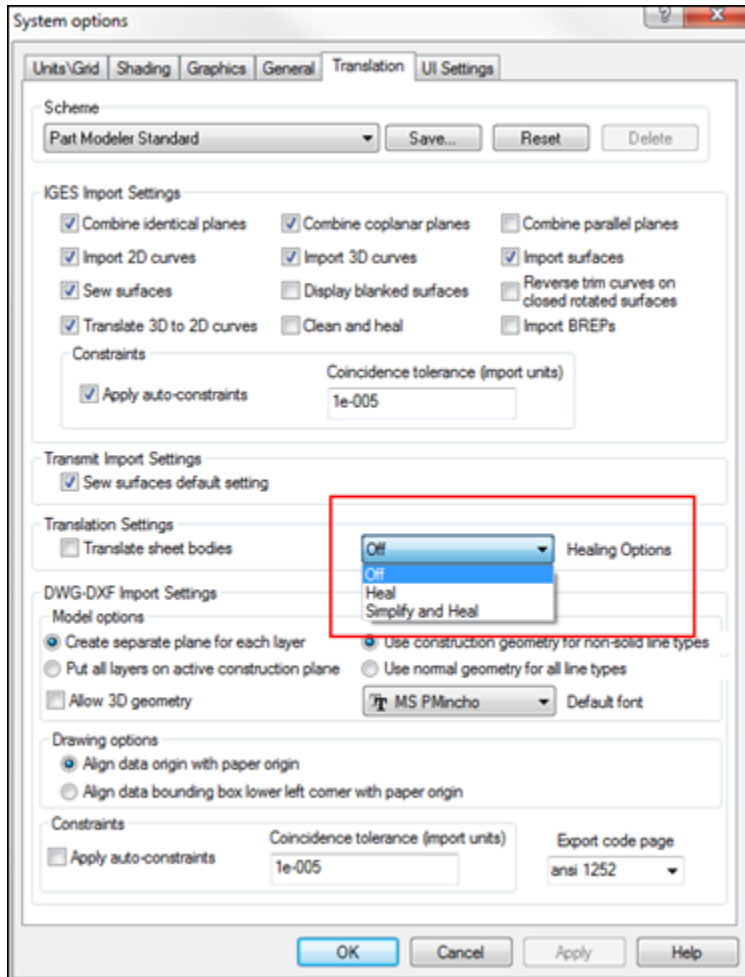

New Radius Dimension Property

We have introduced a new **Apply Inner Leader** property on the General tab of the Radius Dimension Properties. When dimensioning radii, selecting this option causes an inner leader line to be drawn to the centre line; deselecting will allow a shorter leader line and the dimension to be displayed.

See [Radius Dimension Properties Dialog Box](#) for more information.

